

PLAN  
Scale - 1" = 40'

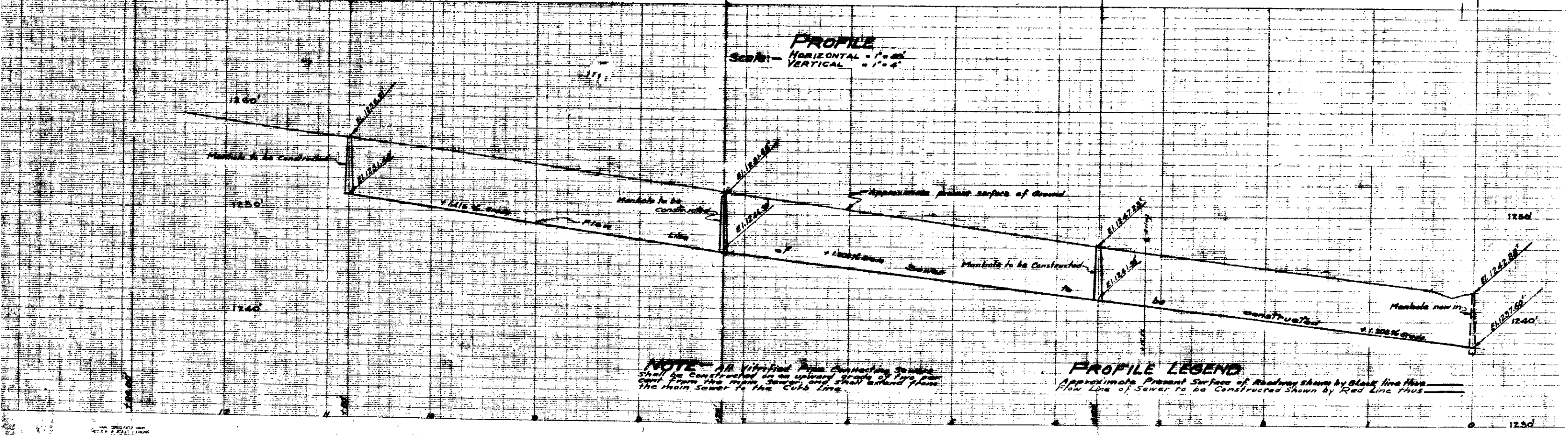

PROFILE  
Series - HORIZONTAL = 1" = 20'  
VERTICAL = 1" = 5'

**NOTE** - All Vitrified Pipe Connection Sewers shall be constructed in an upward grade of two per cent from the main sewer and shall extend from the main sewer to the curb line.

**PROFILE LEGEND**  
Approximate Present Surface of Roadway shown by Black line thus ———  
Flow Line of Sewer to be Constructed shown by Red line thus ———